

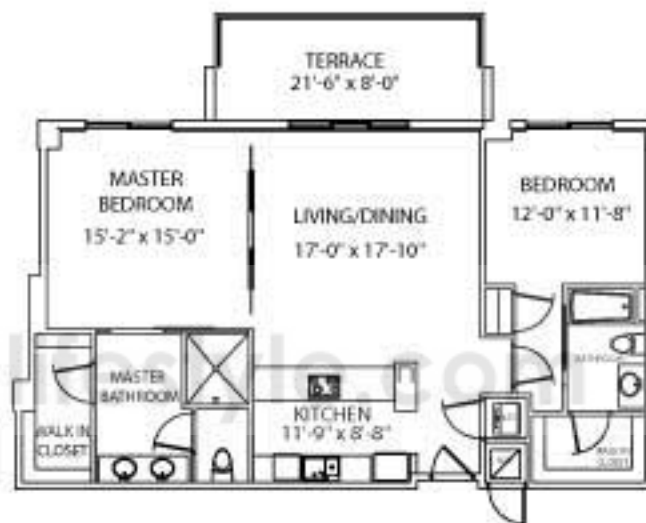

# Unit C



[Previous](#)

[Next](#)

[View PDF](#)

### UNIT C - 2 Bedrooms / 2 Baths

Architect Derived AC  
 Engineer Derived AC (\*)  
 Terrace  
 Roof top Terrace

**Total Architect Derived AC**

### 3rd Floor

1,267.00 sq. ft.  
 (1,191.19) sq. ft.  
 167.00 sq. ft.  
 N/A

**1,434.00 sq. ft.**

### 4th Floor

1,267.00 sq. ft.  
 (1,191.19) sq. ft.  
 167.00 sq. ft.  
 N/A

**1,434.00 sq. ft.**

### 5th Floor

1,267.00 sq. ft.  
 (1,191.19) sq. ft.  
 167.00 sq. ft.  
 1,013.00 sq. ft.

**2,447.00 sq. ft.**