

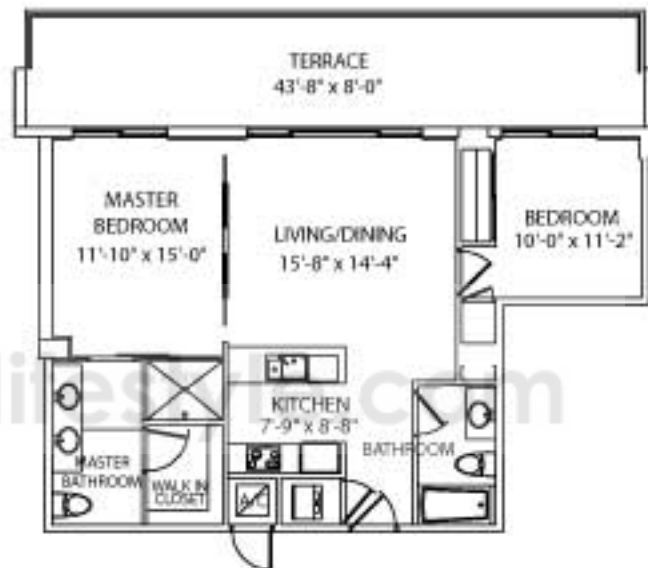

# Unit B



Previous	Next	View PDF		
<b>UNIT B - 2 Bedrooms / 2 Baths</b> Architect Derived AC Engineer Derived AC (*) Terrace Roof top Terrace		<b>3rd Floor</b> 979.00 sq. ft. (908.77) sq. ft. 344.00 sq. ft. N/A	<b>4th Floor</b> 979.00 sq. ft. (908.77) sq. ft. 344.00 sq. ft. N/A	<b>5th Floor</b> 979.00 sq. ft. (908.77) sq. ft. 344.00 sq. ft. 927.49 sq. ft.
<b>Total Architect Derived AC</b>		<b>1,323.00 sq. ft.</b>	<b>1,323.00 sq. ft.</b>	<b>2,250.49 sq. ft.</b>