

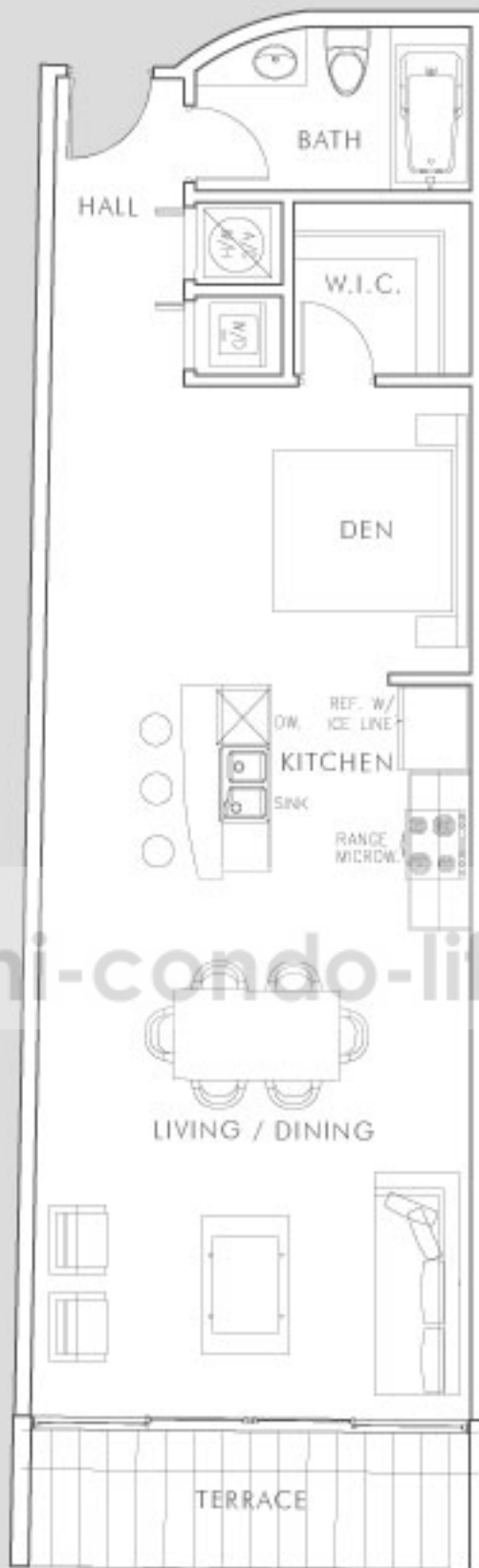

CORRIDOR



www.miami-condo-lifestyle.com

waterfront

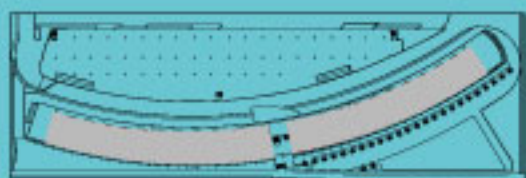
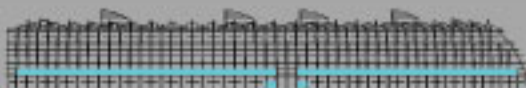

ARTECH
RESIDENCES AT AVENTURA

BACHELOR PAD

total area: **913 sq.ft.**

ALL DIMENSIONS ARE APPROXIMATE AND SUBJECT TO CHANGE, IN ACCORDANCE WITH THE AGREEMENT FOR SALE. Stated dimensions are measured to the exterior boundaries of the exterior walls and do not vary from the dimensions that would be determined by using the description of the "lot" set forth in the Declaration (which generally only includes the space enclosed between the perimeter walls and includes interior structural components). All dimensions are approximate, and all floor plans and development plans are subject to change. The drawings, renderings, graphic materials, plans, specifications, forms, conditions and statements contained in this brochure and attached only, and the Developer reserves the right to modify, revise or withdraw any or all of same in its sole discretion without prior notice. All improvements, designs and construction are subject to first obtaining the appropriate federal, state and local permits and approvals for same. These drawings are conceptual only and are for the convenience of reference. They should not be relied upon as representations, express or implied, of the final state of the building.